

SELECT LEVEL AND STAIR RAIL DETAILS

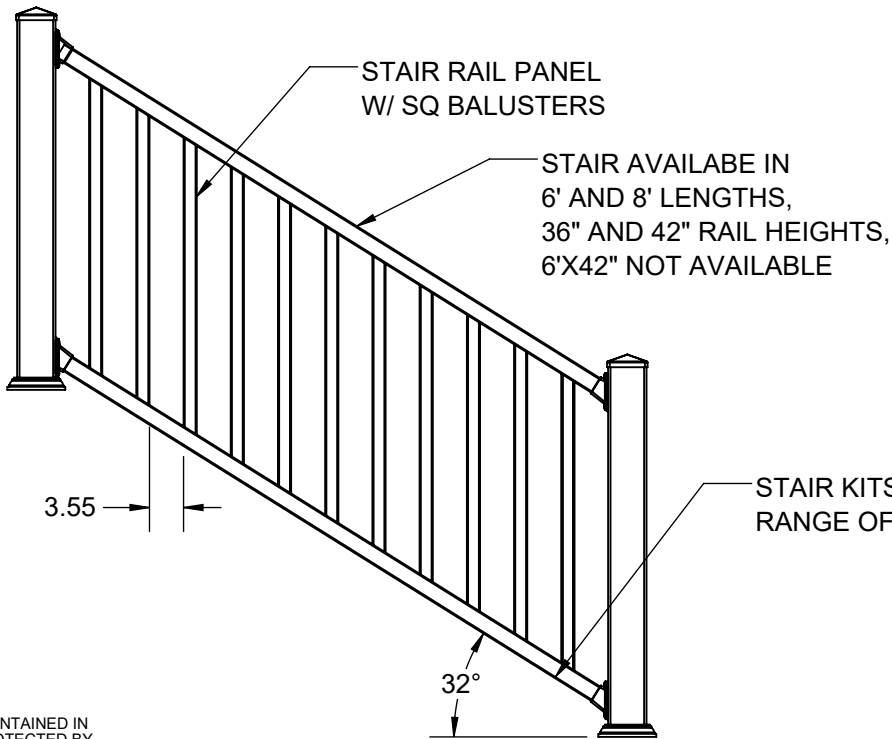
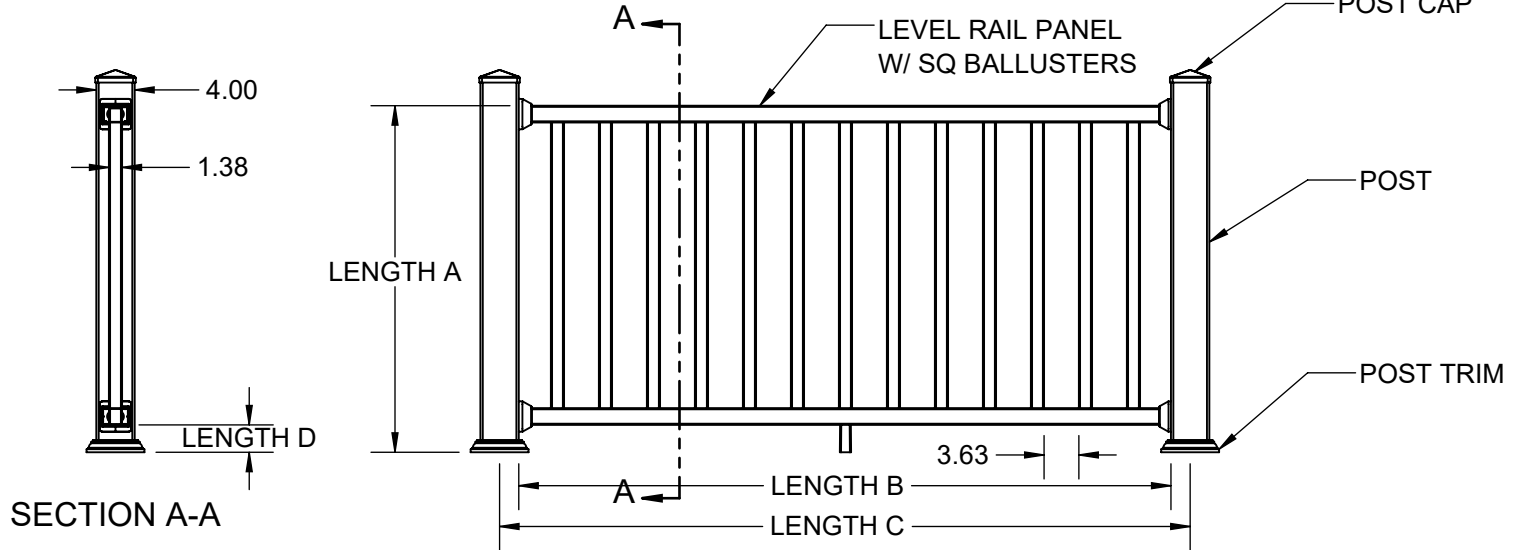

NOTE:
 (A) FINISHED RAIL HEIGHT = 36", 42" (SQ BALLUSTERS ONLY)
 (B) PANEL LENGTH = 67.5", 91.5", 115.5"
 (C) MAX SPANS = 115" (36" HIGH, IRC), 91" (42" HIGH, IBC)
 (D) BOTTOM SPACE = 3"

STAIR KITS HAVE A WORKING RANGE OF 26-38 DEGREES

THE INFORMATION CONTAINED IN THIS DRAWING IS PROTECTED BY COPYRIGHT AND PATENT LAWS OF THE UNITED STATES AND OTHER COUNTRIES. ANY REPRODUCTION IN PART OR AS A WHOLE WITHOUT WRITTEN PERMISSION IS PROHIBITED.

Barrette OUTDOOR LIVING		
DRAWN: CH	DATE: 11/16/2021	APPROVED:
DESCRIPTION: SELECT LEVEL AND STAIR RAIL		
SHEET 1 OF 3	REVISION	PART NUMBER
SCALE 1:20		N/A
WEIGHT: N/A		

TOP AND BOTTOM RAIL

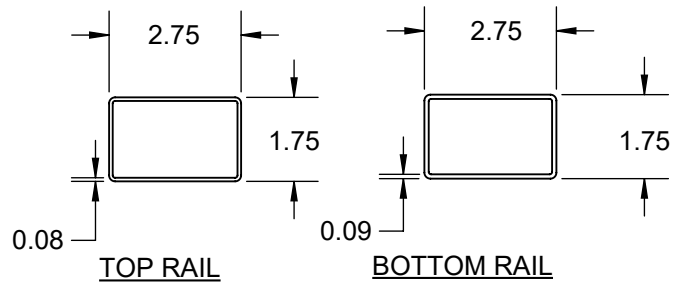

STIFFENER

NOTE: STIFFENER SELECTION DEPENDS ON SPAN OF SELECTION. SEE PFS TECO RESEARCH REPORT 0101.

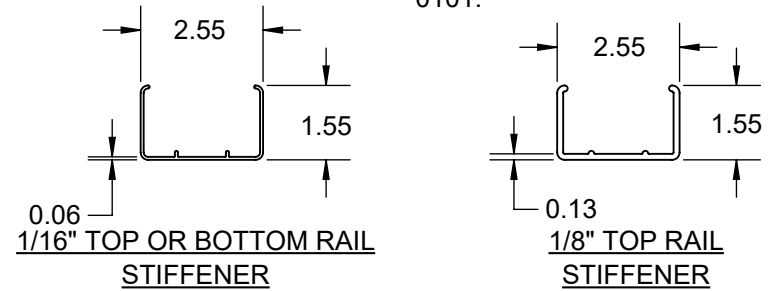

POST COMPONENTS

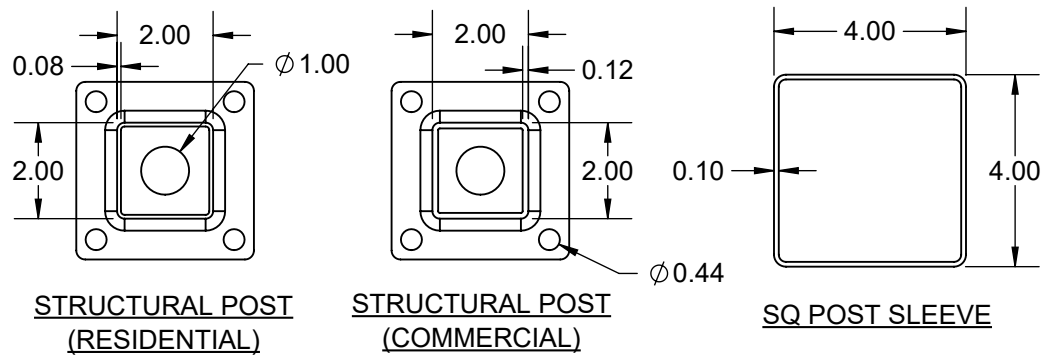

BALUSTERS

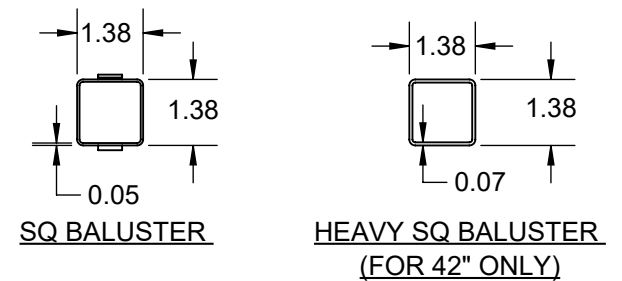

THE INFORMATION CONTAINED IN THIS DRAWING IS PROTECTED BY COPYRIGHT AND PATENT LAWS OF THE UNITED STATES AND OTHER COUNTRIES. ANY REPRODUCTION IN PART OR AS A WHOLE WITHOUT WRITTEN PERMISSION IS PROHIBITED.

Barrette OUTDOOR LIVING		
DRAWN: CH	DATE: 11/16/2021	APPROVED:
DESCRIPTION: BELLA PREMIER PROFILE DETAILS		
SHEET 2 OF 3	REVISION	PART NUMBER
SCALE 1:4		N/A
WEIGHT: N/A		

SELECT POST AND MOUNT DETAILS

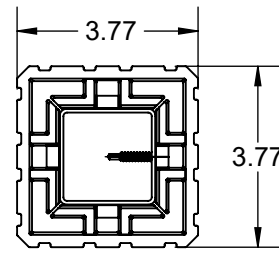
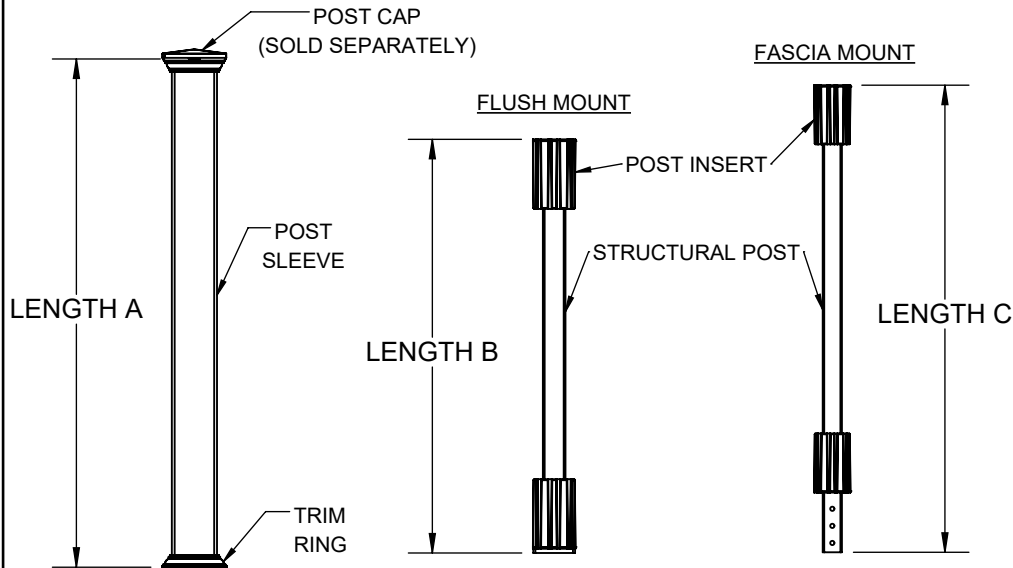

POST INSERT TOP VIEW

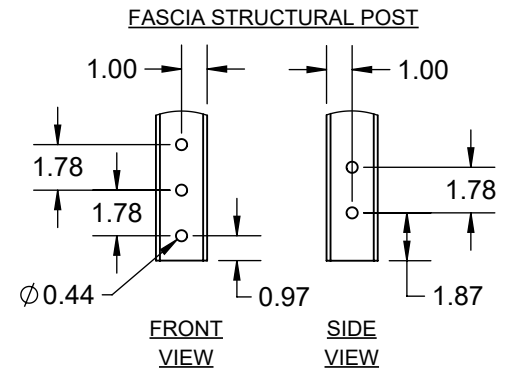

NOTE:
 (A) = 39", 45", 54", 100", 108", 120"
 (B) = 36.625", 42.625"
 (C) = 42.625", 48.625"

POST BASE CONNECTION INTO CONCRETE W/ WEDGE ANCHORS

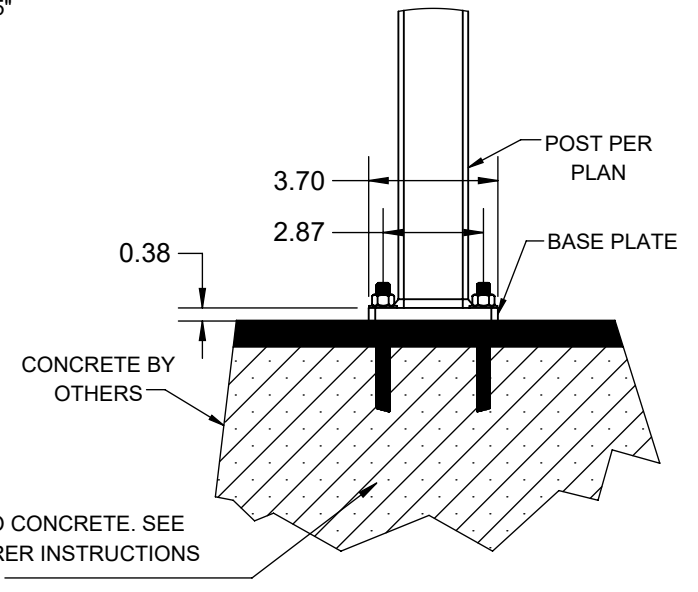
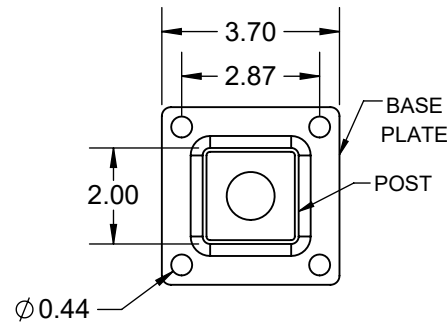
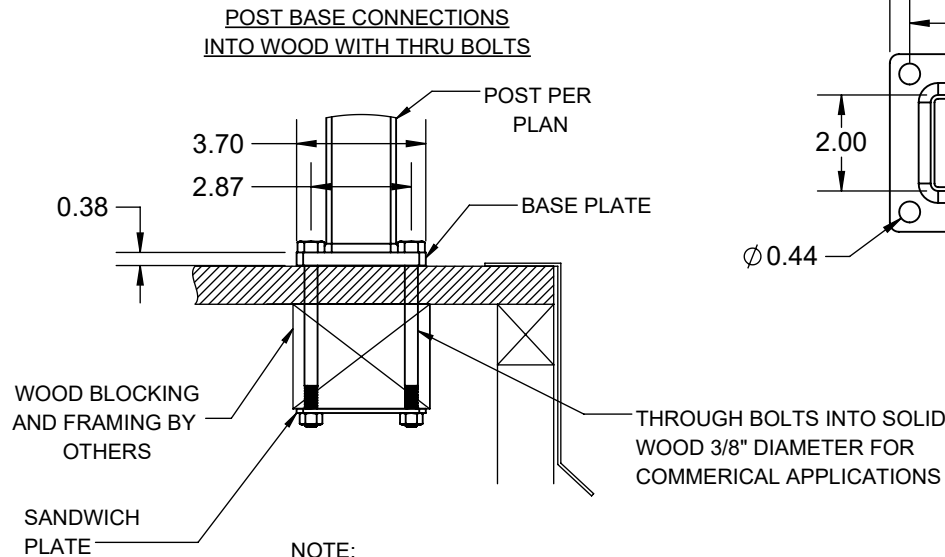

NOTE:
 1. COMMERCIAL APPLICATIONS ARE ALWAYS BOLTED, USE 3/8" DIAMETER A307 THROUGH BOLTS (MIN 5" LENGTH) INTO SOLID WOOD BLOCKING (MIN 4" EMBEDMENT DEPTH).
 2. WOOD BLOCKING BY OTHERS.
 3. BLOCKING MUST BE DESIGNED TO WITHSTAND PROPER LOADING.

THE INFORMATION CONTAINED IN THIS DRAWING IS PROTECTED BY COPYRIGHT AND PATENT LAWS OF THE UNITED STATES AND OTHER COUNTRIES. ANY REPRODUCTION IN PART OR AS A WHOLE WITHOUT WRITTEN PERMISSION IS PROHIBITED.

TOLERANCES						
FRACTION	±1/16	DRAWN:	CH	DATE:	6/7/2021	APPROVED:
XX	±0.01	DESCRIPTION:				
XXX	±0.005	SELECT POST & MOUNT DETAILS				
ANGLE	±1.0°	SHEET 3 OF 3		REVISION	PART NUMBER	
FINISH	125 RMS	SCALE 1:15			N/A	
UNLESS OTHERWISE SPECIFIED		WEIGHT: N/A				