

NEW CASTLE / SOMERSET ALUMINUM RAIL INSTALLATION INSTRUCTIONS

*2 person installation recommended

- 1.) Closely follow post installation instructions.
- 2.) Cut two 3" tall temporary wood spacer blocks (not included) to insert under ends of railing sections to temporarily assist in aligning section *Figure 1*.
- 3.) Slide top and bottom rail brackets on ends of pre-built rail sections *Figures 2 & 3*.
- 4.) Slide rail section and brackets between posts and on top of temporary wood spacer blocks. (Position wood spacer blocks next to installed aluminum posts) *Figure 1*.
- 5.) Using a $\frac{1}{8}$ " drill bit, carefully pre-drill all four bottom bracket screw holes on one post *Figure 4*.
- 6.) Install $\frac{3}{4}$ " screws (included) to attach bracket to post *Figure 5*.
- 7.) Repeat steps 5 & 6 for second bottom bracket.
- 8.) Using a $\frac{1}{8}$ " drill bit, pre-drill all four top bracket screw holes on one post *Figure 6*.
- 9.) Install $\frac{3}{4}$ " screws (included) to attach bracket to post *Figure 7*.
- 10.) Repeat steps 8 & 9 for second top rail bracket.
- 11.) Using a $\frac{1}{8}$ " drill bit, pre-drill all brackets (top and bottom) through side hole *Figure 8*.
- 12.) Install $\frac{3}{4}$ " screws (included) into side bracket holes to attach brackets to rails *Figure 9*.

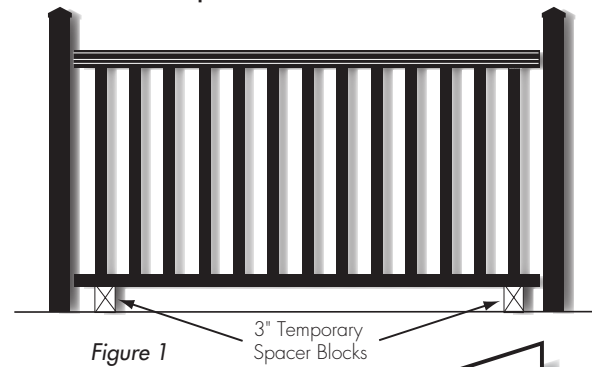

Figure 1

3" Temporary
Spacer Blocks

Figure 2

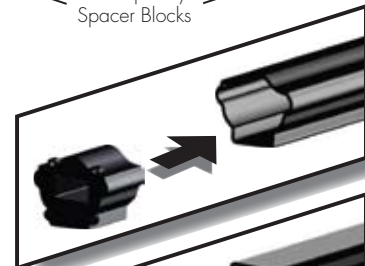

Figure 3

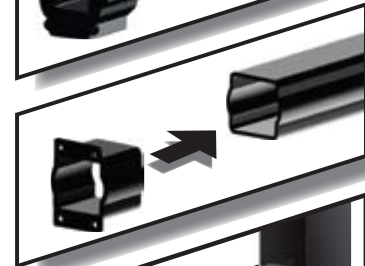

Figure 4

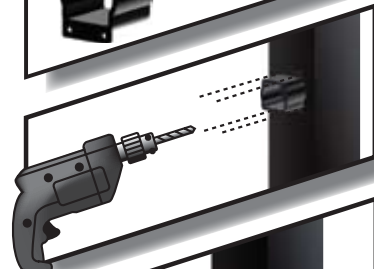

Figure 5

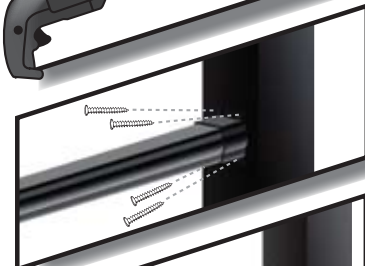

Figure 6

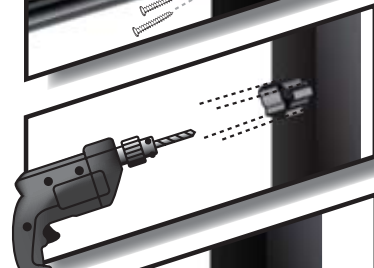

Figure 7

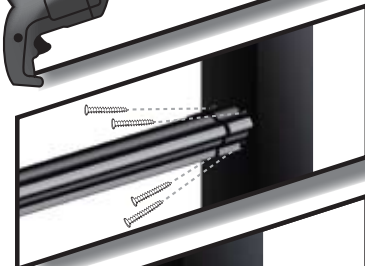

Figure 8



Figure 9

